

4.0T AIR OPERATED POWER PACK ASSEMBLY

Part Number 1753 Alt H1753

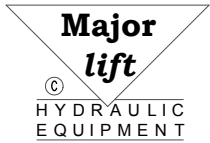
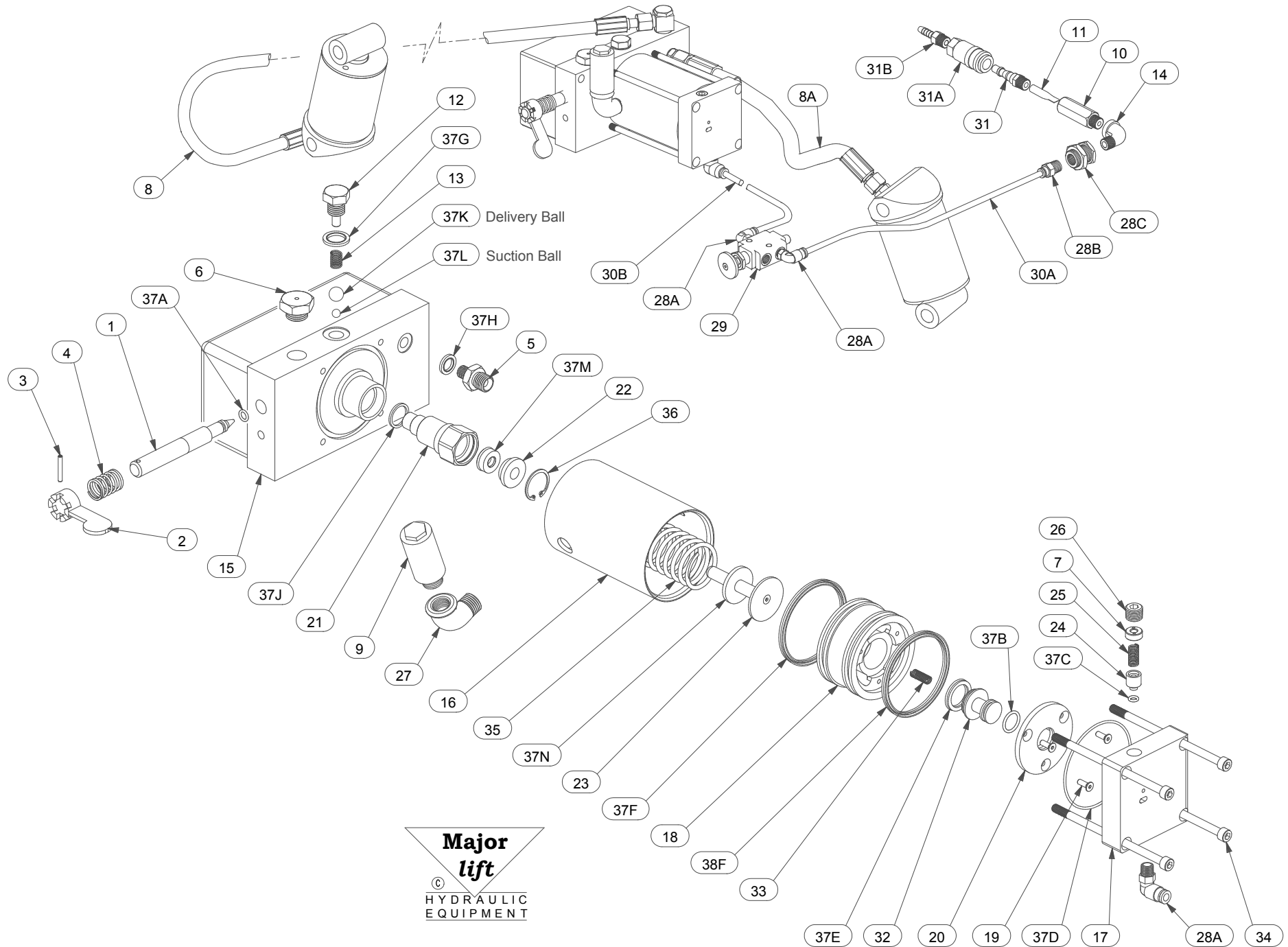

4.0 TONNE AIR OPERATED POWER PACK ASSEMBLY

Part Number 1753 Alt H1753

<u>ITEM No.</u>	<u>DESCRIPTION</u>		<u>QTY</u>	<u>PART No.</u>
1	RELEASE SPINDLE		1	160304
2	RELEASE LEVER		1	110307
3	LEVER RETAINING PIN		1	110308
4	RELEASE LEVER SPRING		1	110310
5	OUTLET UNION		1	110311
6	FILLER PLUG		1	110312
7	RELIEF VALVE ADJUSTING COLLAR		1	110315
8	HYDRAULIC HOSE ASSEMBLY	LH RAM	1	1725
8A	HYDRAULIC HOSE ASSEMBLY	RH RAM	1	1726
9	SILENCER		1	120315
10	INLET FILTER BODY		1	1210
11	AIR INLET FILTER		1	1211
12	DELIVERY VALVE PLUG		1	140302L
13	DELIVERY VALVE SPRING		1	140304L
14	ELBOW		1	1427
15	VALVE BLOCK ASSEMBLY		1	175301 Alt H175301
16	AIR CYLINDER		1	145302
17	CYLINDER AIR CAP		1	145303
18	AIR PISTON		1	145304
19	C'SUNK SCREW		3	791111
20	PISTON END PLATE		1	145305
21	PUMP BARREL		1	145308
22	PLUNGER GLAND		1	145309
23	PUMP PLUNGER ASSEMBLY		1	145310
24	RELIEF VALVE PISTON		1	145311
25	RELIEF VALVE SPRING		1	145312
26	RELIEF VALVE CAP		1	145313
27	ELBOW		1	145314
28	AIR VALVES AND FITTINGS KIT	(Containing Items 28A to 28C)	1	1757
28A	SWIVEL ELBOW ADAPTOR		3	
28B	STRAIGHT ADAPTOR		1	
28C	BULKHEAD FITTING		1	
29	CONTROL VALVE		1	1752
30	POLYURETHANE TUBE SET		1	1758
31	AIR INLET TAILPIECE		1	39101
31A	AIR INLET CHUCK	Optional Extra	1	39102
31B	AIR HOSE CONNECTOR	Optional Extra	1	39103
32	SHUTTLE VALVE		1	791106
33	SHUTTLE VALVE SPRING		1	791107
34	CYLINDER CAP HEAD SCREW		4	791112
35	AIR PISTON RETURN SPRING		1	791113
36	GLAND RETAINER		1	850306
37	SEAL KIT	(Containing Items 37A to 37N)	1	1453K
37A - D	'O' RING		4	
37E - F	'U' RING		3	
37G - H	BONDED SEAL		2	
37J	COPPER WASHER		1	
37K - L	BALLS		2	
37M	ROD SEAL		1	
37N	PU WASHER		1	